

Type:_____ Qty:_____

Project:_____



HELIUM LYTE

INSPIRA MULTI

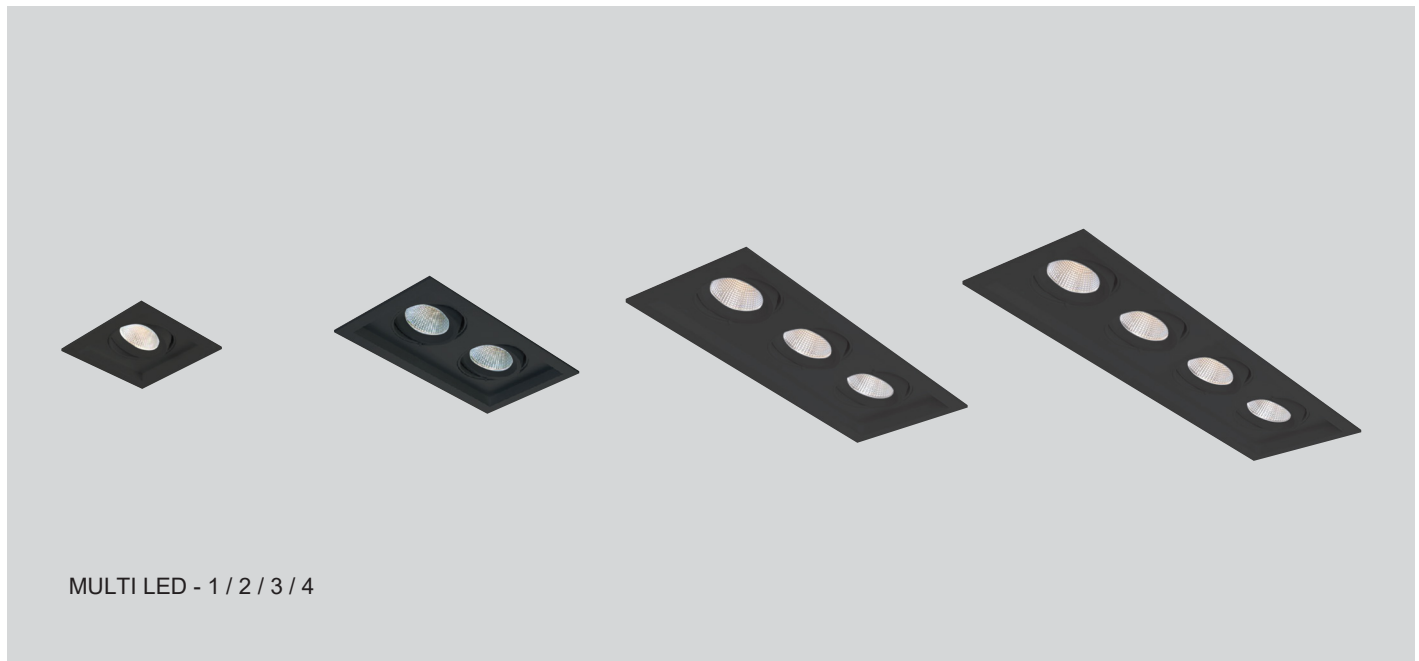

MULTI LED - 1 / 2 / 3 / 4

Design Features:

- Made with high powered BRIDGELUX led chip that maintains high lumens per watt with 90 +CRI / Fixture comes with both Single CCT and Dim To Warm options.
- The gimbal led heads can rotate 360 degree horizontally and tilt 30 degree.
- Integral thermal protection provided on Non-IC models to indicate improper installations.
- Available in both TRIAC and 0-10V dimming.
- LED modules and drivers are easily replaceable.
- Standard remodel installation, new construction housing available.
- Modules are IC Rated available in wattage up to 14W without additional IC box.
- Extruded aluminium heat sink ensures optimal heat dissipation and LED life.
- 5 Year warranty.



Warranty



Damp Rated



TRIAC



Dimming



Intertek



INSPIRA MULTI

Specs Code:

FIXTURE ID 1	TRIM FINISH 2	NO. OF LIGHTS / LUMENS / WATT 3		CRI / LED OPTION 4
Inspira INSMULTI-MC Multi -Multi Colour	White WH	1 Light - L700 / 10W	1L-L07/10	90 CRI / 5CCT 90/5CCT
	Black BK	2 Light - L1400 / 20W	2L-L14/20	
	Chrome CH	3 Light - L2100 / 30W	3L-L21/30	
		4 Light - L2800 / 40W	3L-L28/40	
BEAM ANGLE 5	DIMMING 6	VOLTAGE 7		
15 Degree 15D	TRIAC TRIAC	120V	120V	
24 Degree 24D	0-10V DMV	120-277V	UNV	
36 Degree 36D				

Order Guide:

1	2	3	4	5	6
<input type="text"/>	<input type="text"/>	<input type="text"/>	<input type="text"/>	<input type="text"/>	<input type="text"/>
7					
<input type="text"/>					

*Example : INSMULTI-MC-BK--1L-L07/10W-90/5CCT-36D-TRIAC-UNV



INSPIRA MULTI

Product Details:

MULTI LED - 1 Light

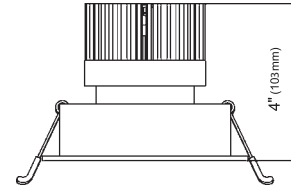
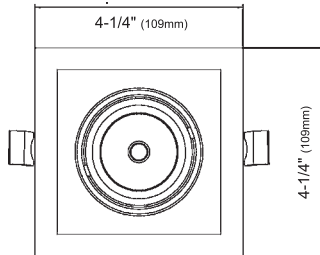
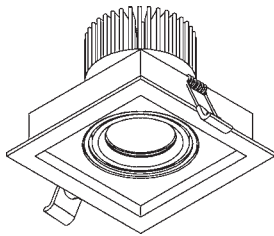

CUT-OUT : 3-3/4" × 3-7/8" (95mm × 98mm)

MULTI LED - 2 Light

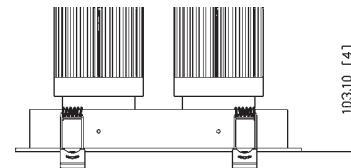
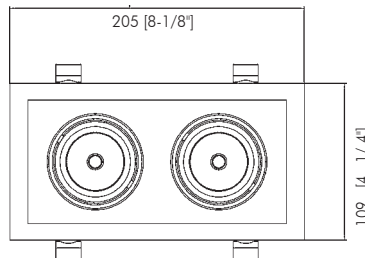
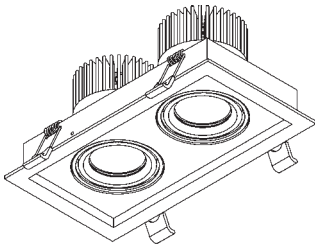

CUT-OUT : 3-7/8" × 7-1/2" (98mm × 190mm)

*All Dimensions are millimeters (Inches) unless otherwise indicated.



Warranty



Damp Rated



TRIAC



Dimming



Intertek

INSPIRA MULTI

Product Details:

MULTI LED - 3 Light

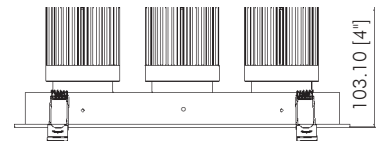
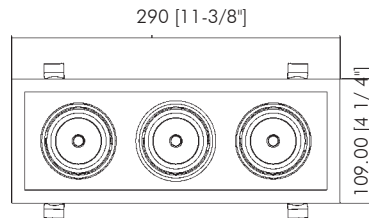
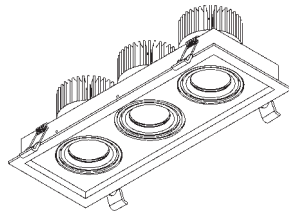

CUT-OUT : 3-7/8" × 10-13/16" (98mm × 275mm)

MULTI LED - 4 Light

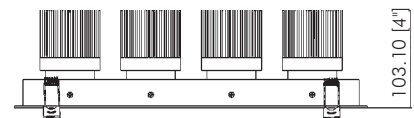
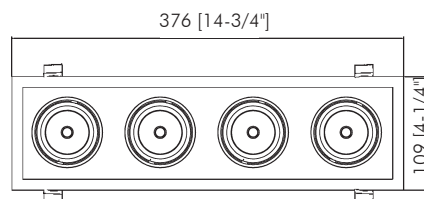
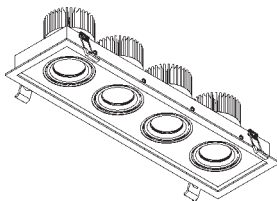

CUT-OUT : 3-7/8" × 14-1/4" (98mm × 361 mm)

*All Dimensions are millimeters (Inches) unless otherwise indicated.



Warranty



Damp Rated



TRIAC



Dimming



Intertek

INSPIRA MULTI

Product Details:

New construction housing plate for Multi Downlight

Part number - 503048

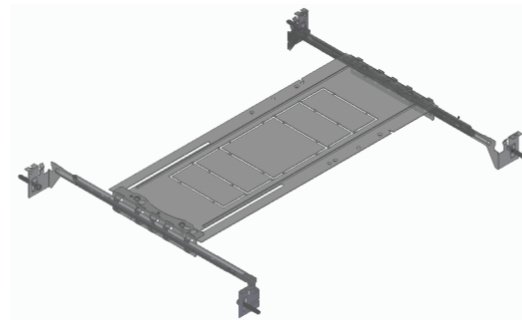
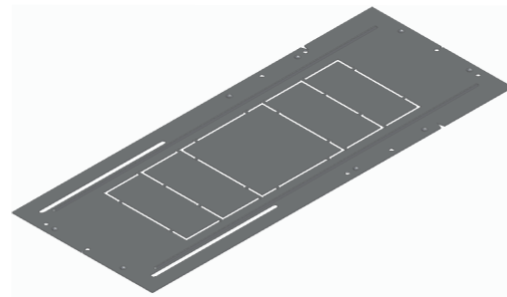
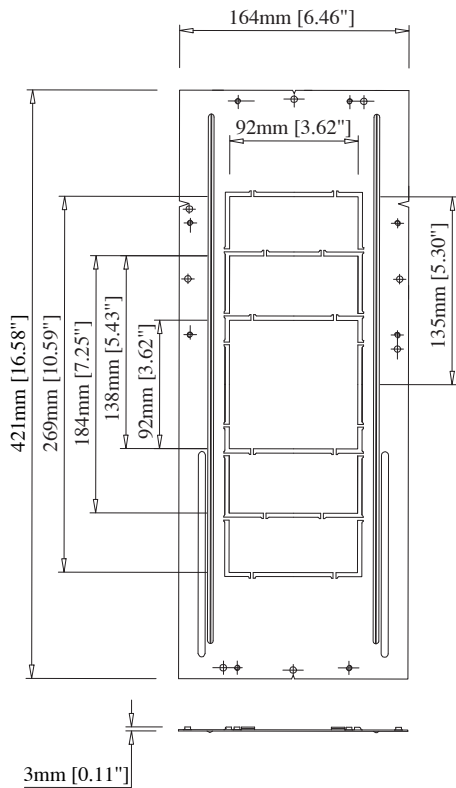

Warranty



Damp Rated



Dimming



Dimming



Intertek



INSPIRA MULTI

Mounting Details:

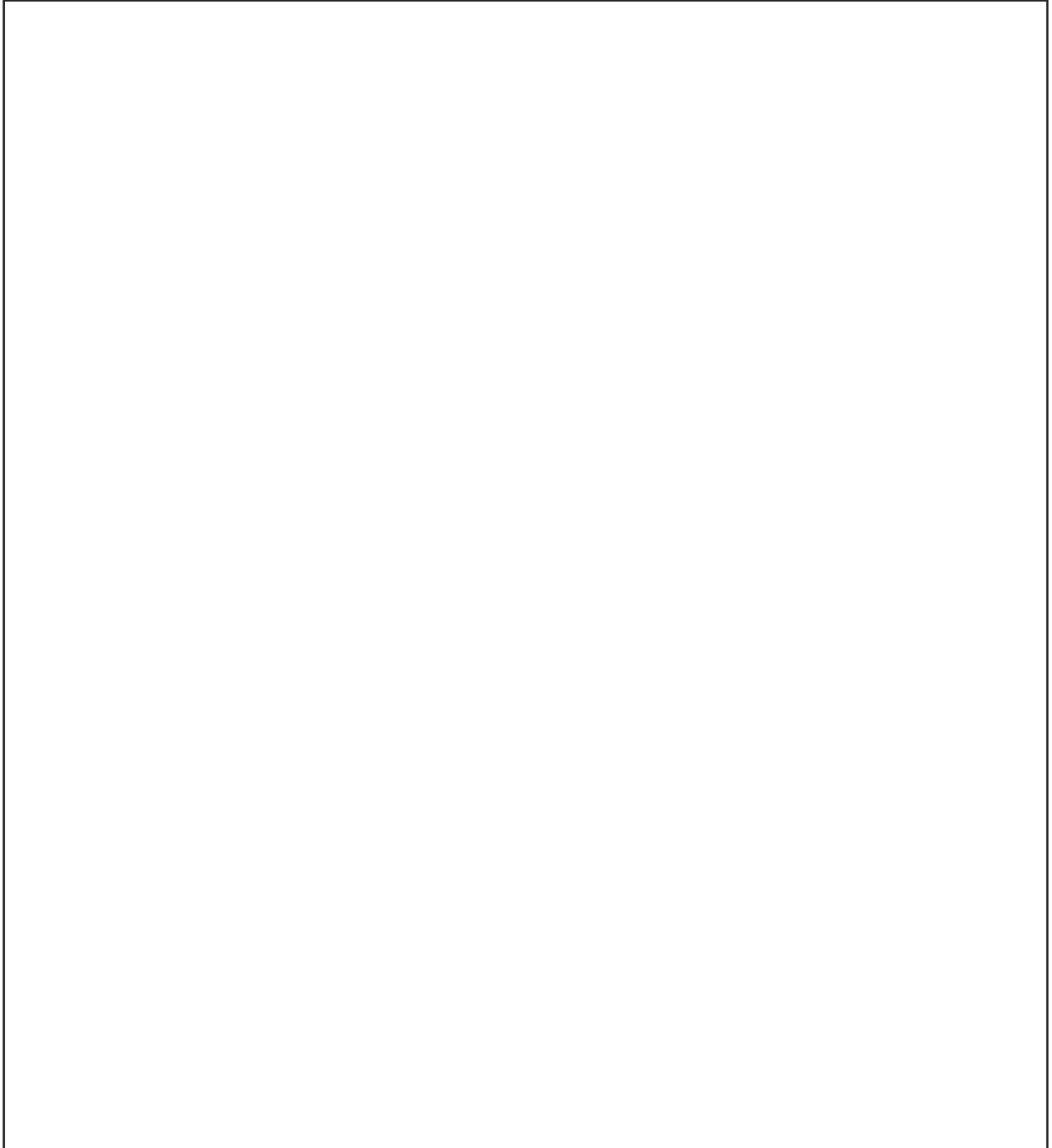

Warranty



Damp Rated



TRIAC



Dimming



Intertek

INSPIRA MULTI

Photometric:

Round -10W-36D

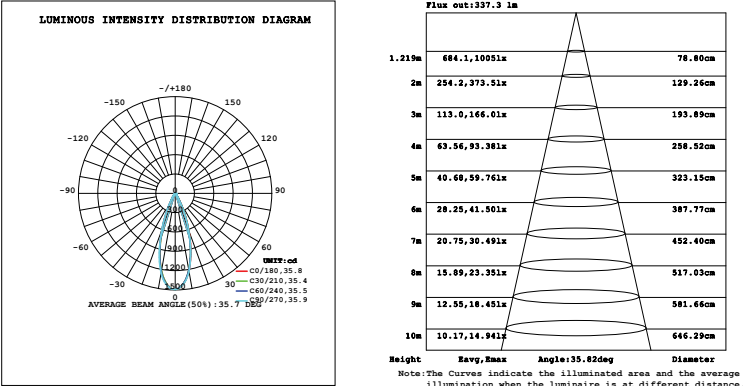

Lighting Chart:

WATT	LUMENS	CCT	CRI
10W	700 lm	3000K	CRI90
20W	1400 lm	3000K	CRI90
30W	2100 lm	3000K	CRI90
40W	2800 lm	3000K	CRI90





INSPIRA MULTI

Driver Details:

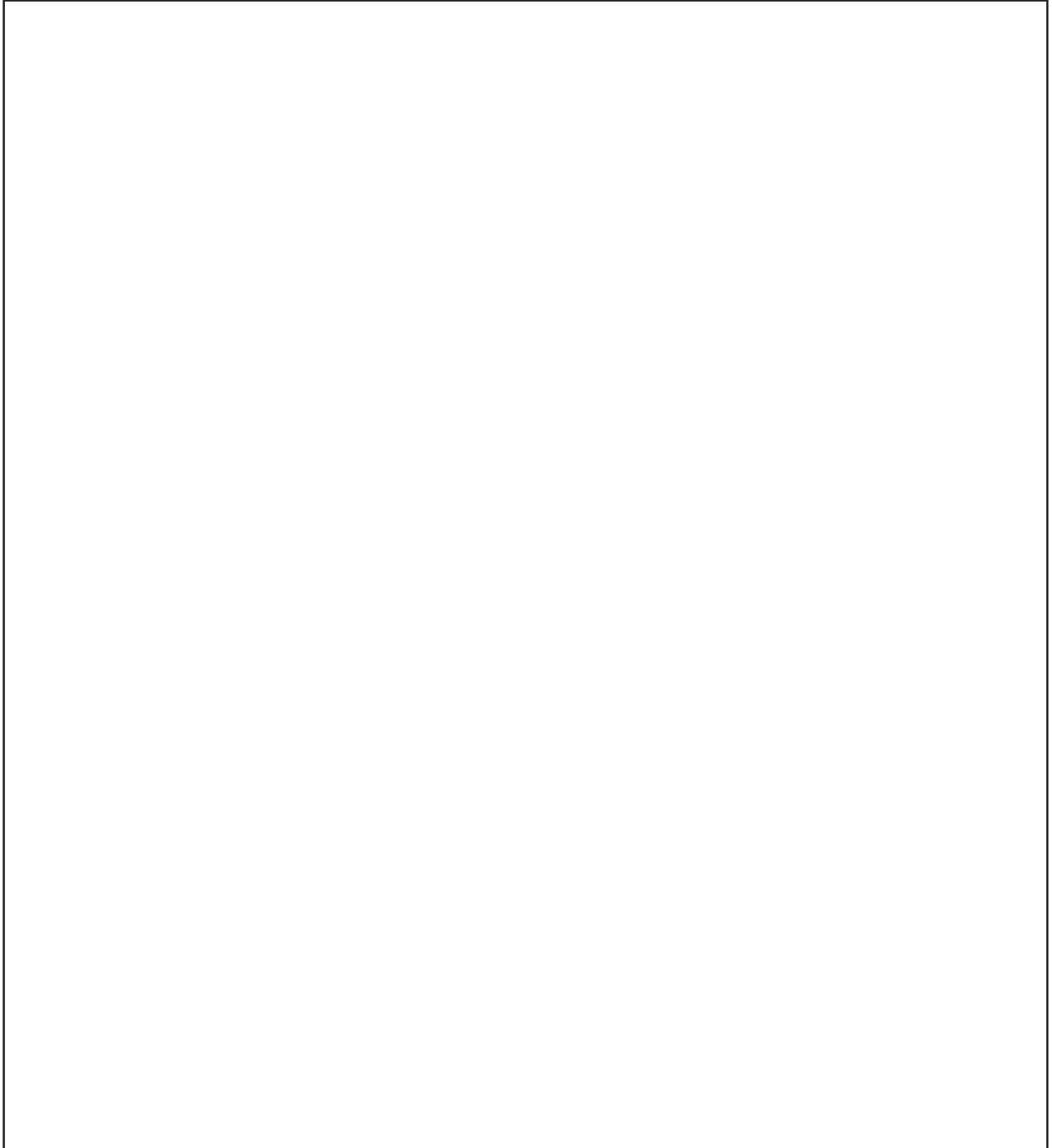

Warranty



Damp Rated



TRIAC



Dimming



Intertek

INSPIRA MULTI

Technical Details:

Material	Aluminium
Trim Options	Trim
Trim Style	Fixed
Trim Finish	White / Black
Lumens	Upto 2800lm
No.of Light -Wattage	1L-10W / 2L-20W / 3L-30W / 4L-40W
Efficacy	70 Lm/W
UGR	<19
CRI	90+
CCT	(2700K / 3000K / 3500K / 4000K / 5000K)
	5CCT
Beam Angle	15° / 24° / 36°
Dimming	TRIAC / 0-10V
Voltage	120V / 120-277V
Life expectancy	LM 80 > 66,000 Hrs. / LM 70 > 66,000 Hrs.
Operating Temp.	-20°C ~ 40°C (-4°F ~ 104°F)
Housing	Non IC Rated / IC Rated / Remodel
Certification	ETL LISTED / DAMP RATED

