

Type:_____ Qty:_____

Project:_____



HELIUM LYTE

INSPIRA 3

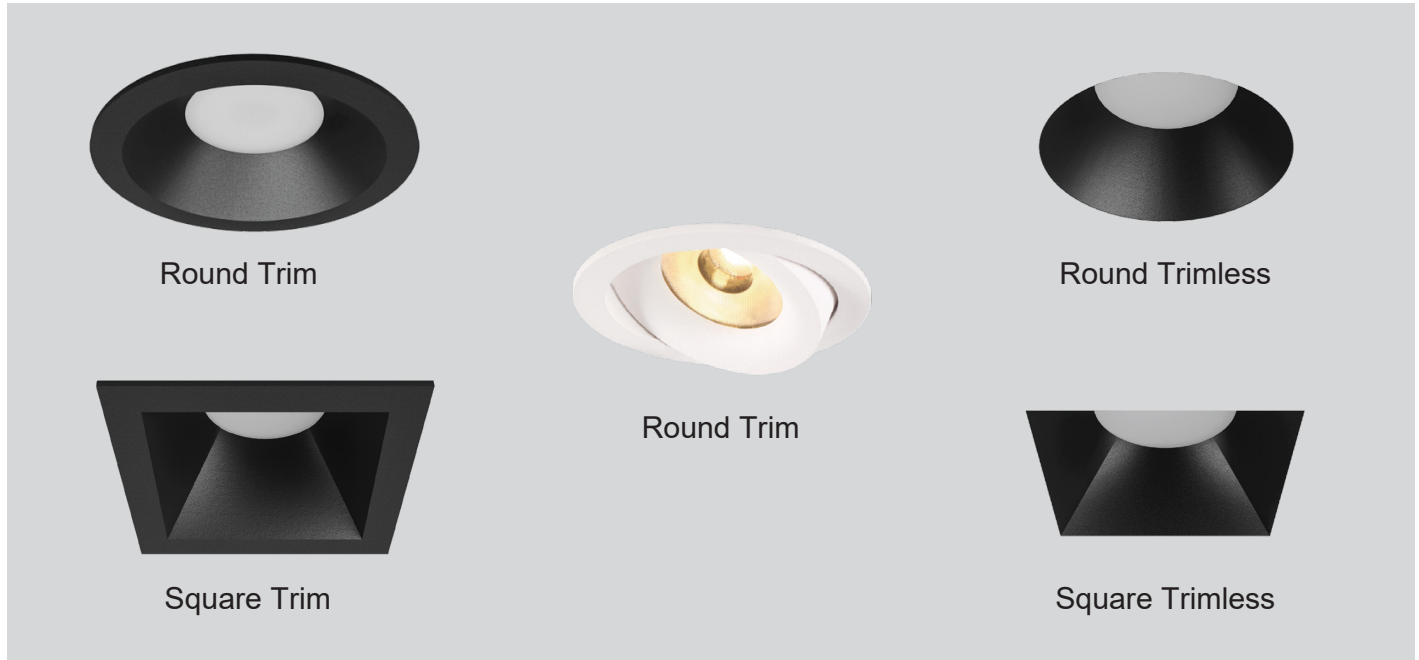

Design Features:

- Inspira 2D fixed 3" Downlight offers specification-grade performance and features, in a completely modular & field-configurable system. Every light engine integrates with any of the trims, and every trim works with all of the ceiling application and housing options.
- Made with high powered BRIDGELUX led chip that maintains high lumens per watt with 90 +CRI / Fixture comes with both Single CCT and Dim To Warm options.
- Available in both TRIAC and 0-10V dimming.
- Standard remodel installation, new construction housing available.
- LED modules and drivers are easily replaceable.
- Modules are IC Rated available in wattage up to 14W without additional IC box.
- Extruded aluminium heat sink ensures optimal heat dissipation and LED life.
- 5 Year warranty.



Warranty



Damp Rated



TRIAC



Dimming



Intertek

INSPIRA 3

Specs Code:

FIXTURE ID 1	TRIM OPTION 2	TRIM FINISH 3	LUMENS/ WATT 4	CRI / LED OPTION 5
Inspira 3- Single Colour	Round Trim RD Round Trimless RDTRL Round Gimbal GMBL	White WH Black BK Custom Colour CC	L1000 / 12W L10/12	90 CRI / 2700K 927
			L1200 / 14W L12/14	90 CRI / 3000K 930
			L2200 / 24W L22/24	90 CRI / 3500K 935
Inspira 3- Multi Colour	Square Trim SQ Square Trimless SQTRL			90 CRI / 4000K 940
				90 CRI / 5000K 950
				90 CRI / 5CCT* 90/5CCT 90 CRI /DTW* DTW (1800-3000K)
BEAM ANGLE 6	DIMMING 7	VOLTAGE 8		
15 Degree 15D	TRIAC TRIAC 0-10V [#] DMV	120V 120V		
24 Degree 24D		120-277V UNV		
36 Degree 36D				
60 Degree 60D				

*5CCT and DTW options are exclusively available with the INS3DMC Multi-Colour model.

[#]Standard 120V drivers do not support 0-10V dimming control.

Order Guide:

1

2

3

4

5

6

7

8

*Example : INS3DMC-RD-BK-L10/12-90/5CCT-60D-TRIAC-UNV

Accessories :

	For Round [503046]	For Square [503047]
New Construction Plate		



INSPIRA 3

Product Details:

Round Bevel Trim Fixed

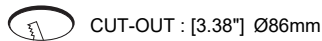
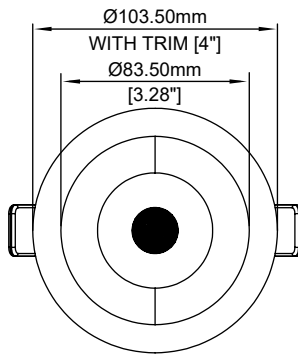
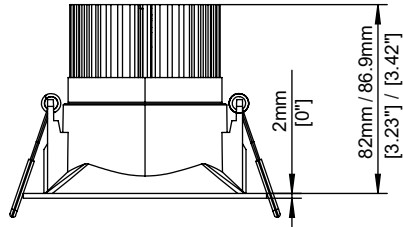

Round Bevel Trimless Fixed

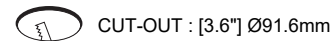
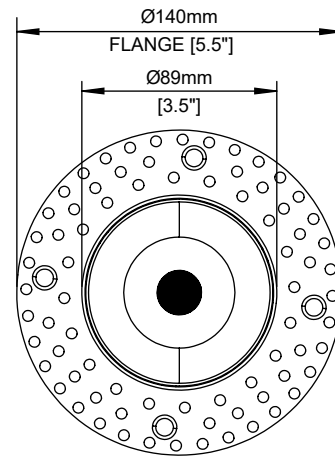
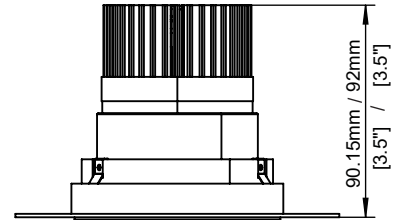

Round Gimbal

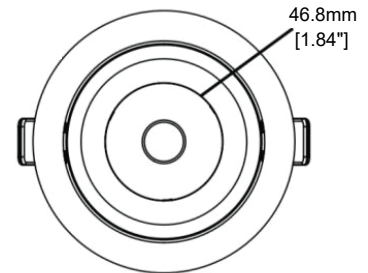
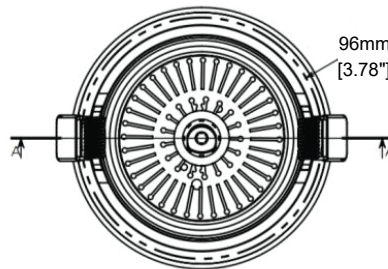
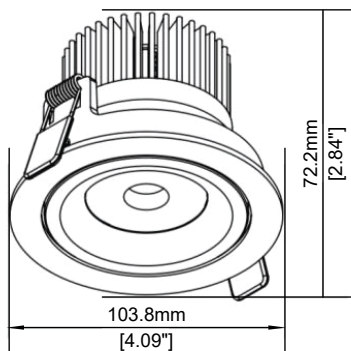

*All Dimensions are millimeters (Inches) unless otherwise indicated.



INSPIRA 3

Product Details:

Square Bevel Trim Fixed

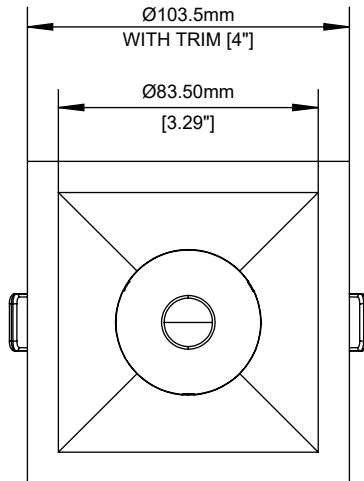
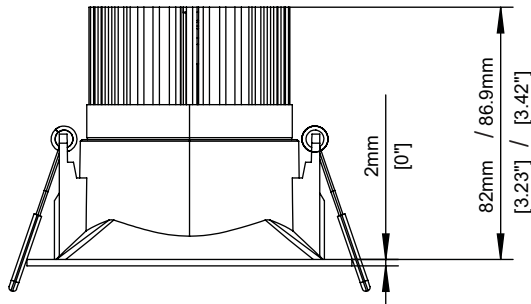

 CUT-OUT : [3.38"] Ø86mm X [3.38"] Ø86mm

Square Bevel Trimless Fixed

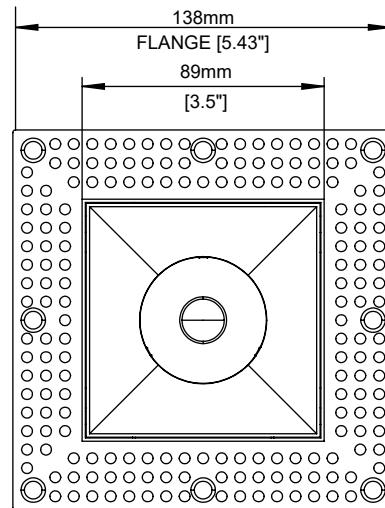
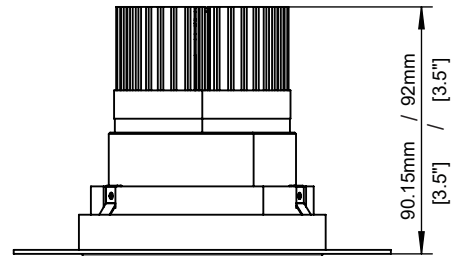

 CUT-OUT : [3.6"] Ø91.6mm X [3.6"] Ø91.6mm

*All Dimensions are millimeters (Inches) unless otherwise indicated.

5
Year
Warranty

IP44
Damp Rated

TRIAC

0-10V
Dimming



ETL
Intertek

INSPIRA 3

Product Details:

New construction housing plate for Round Downlight

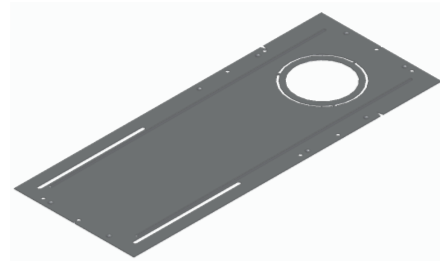
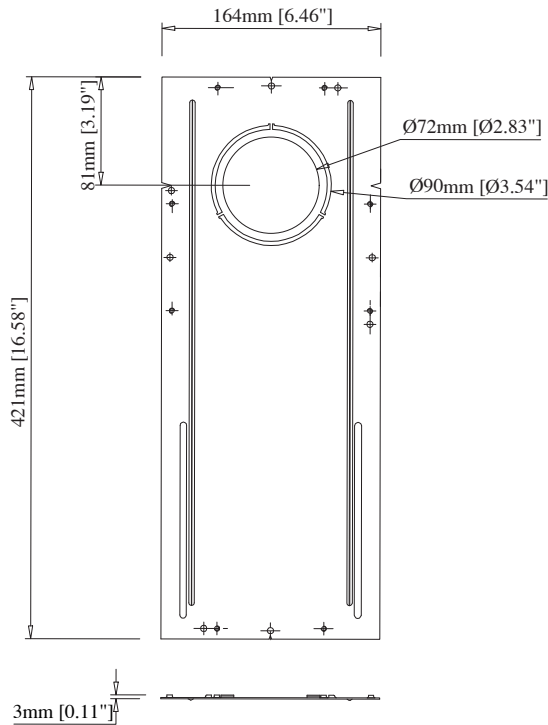
Part number - 503046



New construction housing plate for Round Gimbal Downlight

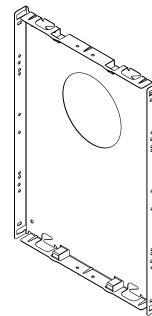
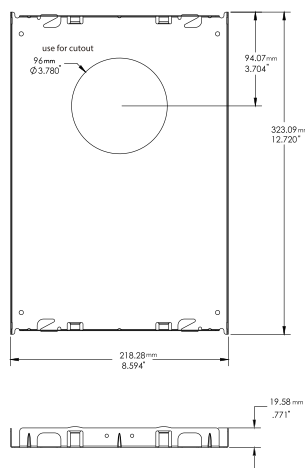

INSPIRA 3

Product Details:

New construction housing plate for Square Downlight

Part number - 503047

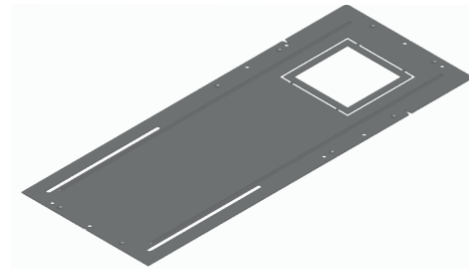
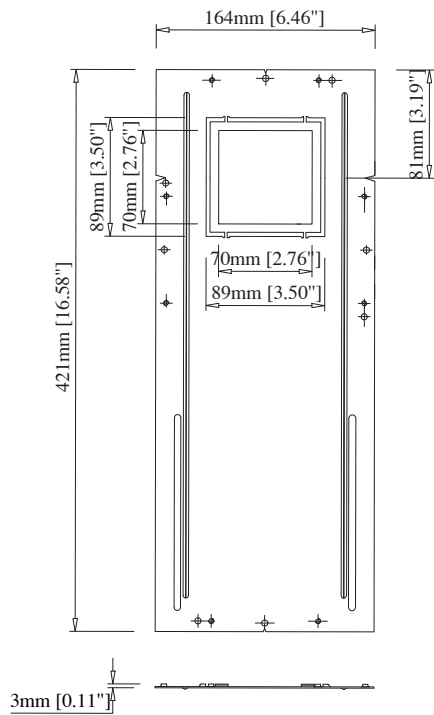

Warranty



Damp Rated



Dimming



Dimming



Intertek

INSPIRA 3

Photometric:

Round Fixed -12W-36D

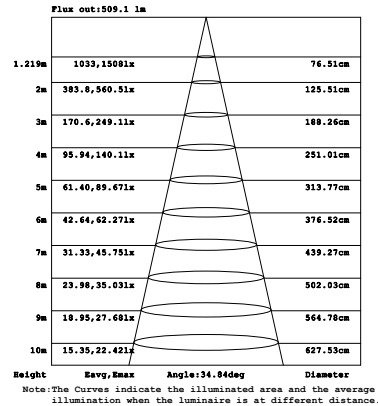
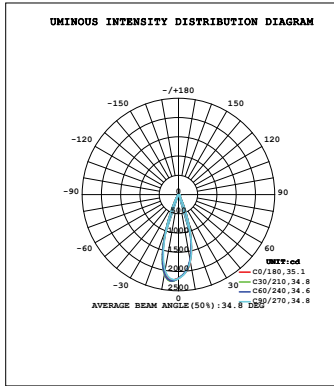

Round Fixed -14W-36D

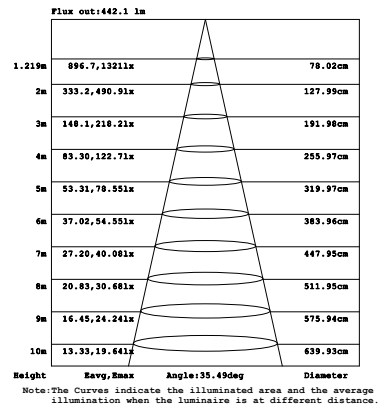
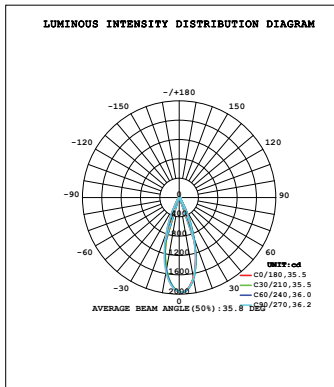

Lighting Chart:

WATT	LUMENS	CCT	CRI
12W	1000 lm	3000K	CRI90
14W	1200 lm	3000K	CRI90
24W	2200 lm	3000K	CRI90



INSPIRA 3

Technical Details:

Material	Aluminium
Trim Options	Trim / Trimless
Trim Style	Fixed / Gimbal Adjustable
Trim Finish	White / Black
Lumens	Upto 2200lm
Wattage	12W / 14W / 24W
Efficacy	80 Lm/W
UGR	<19
CRI	90+
CCT	2700K / 3000K / 3500K / 4000K / 5000K
	5CCT / DTW (1800K-3000K)
Beam Angle	15° / 24° / 36° / 60°
Dimming	TRIAC / 0-10V
Voltage	120V / 120-277V
Life expectancy	LM 80 > 66,000 Hrs. / LM 70 > 66,000 Hrs.
Operating Temp.	-20°C ~ 40°C (-4°F ~ 104°F)
Housing	Non IC Rated / IC Rated / Remodel
Certification	ETL LISTED / DAMP RATED

