

Type: \_\_\_\_\_ Qty: \_\_\_\_\_

Project: \_\_\_\_\_



HELIUM LYTE

# INSPIRA 3

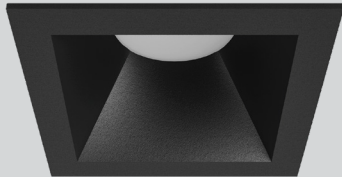

Square Trim

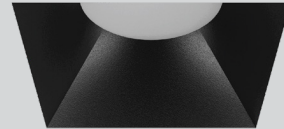

Square Trimless

## Design Features:

- Inspira 2D fixed 3" Downlight offers specification-grade performance and features, in a completely modular & field-configurable system. Every light engine integrates with any of the trims, and every trim works with all of the ceiling application and housing options.
- Made with high powered BRIDGELUX led chip that maintains high lumens per watt with 90 +CRI / Fixture comes with both Single CCT and Dim To Warm options.
- Available in both TRIAC and 0-10V dimming.
- Standard remodel installation, new construction housing available.
- LED modules and drivers are easily replaceable.
- Modules are IC Rated available in wattage up to 14W without additional IC box.
- Extruded aluminium heat sink ensures optimal heat dissipation and LED life.
- 5 Year warranty.



Warranty



Damp Rated



TRIAC



Dimming



Intertek

# INSPIRA 3

Specs Code:

FIXTURE ID <span>1</span>	TRIM OPTION <span>2</span>	TRIM FINISH <span>3</span>	LUMENS/ WATT <span>4</span>	LED OPTION <span>5</span>
Inspira 3 Square <b>INS3SQ</b>	Trim <b>TR</b>	White <b>WH</b>	L1000 / 12W <b>L10/12W</b>	2700K <b>27K</b>
	Trimless <b>TRL</b>	Black <b>BLK</b>	L1200 / 14W <b>L12/14W</b>	3000K <b>30K</b>
		Custom <b>CSTM</b>	L2200 / 24W <b>L22/24W</b>	3500K <b>35K</b>
				4000K <b>40K</b>
				5000K <b>50K</b>
				Dim To Warm <b>DTW</b>
BEAM ANGLE <span>6</span>	DIMMING <span>7</span>	HOUSING <span>8</span>	VOLTAGE <span>9</span>	
15 Degree <b>15D</b>	TRIAC <b>TRIAC</b>	New Construction <b>NC</b>	120V <b>120V</b>	
24 Degree <b>24D</b>	0-10V <b>DMV</b>	IC Rated Housing <b>IC</b>	120-277V <b>UNV</b>	
36 Degree <b>36D</b>		Remodel <b>RMOD</b>		
60 Degree <b>60D</b>				

Order Guide:

1

2

3

4

5

6

7 
8 
9 

\*Example : INS3SQ-TR-BLK-L10/12W-40K-60D-TRIAC-NC-UNV



# INSPIRA 3

## Product Details:

### Square Bevel Trim Fixed

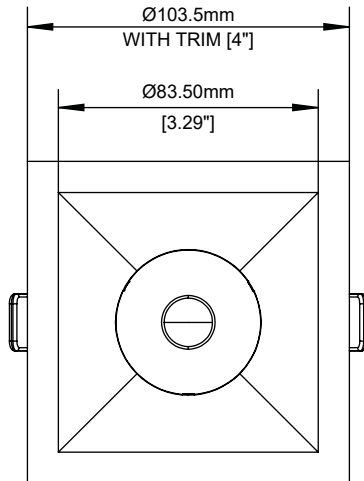
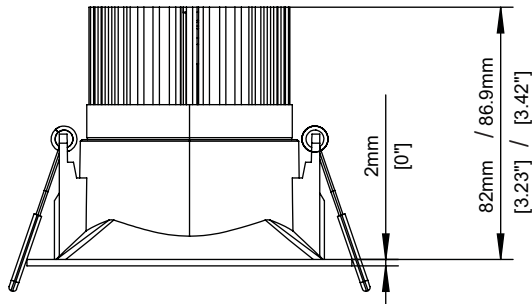

 CUT-OUT : [3.38"] Ø86mm X [3.38"] Ø86mm

### Square Bevel Trimless Fixed

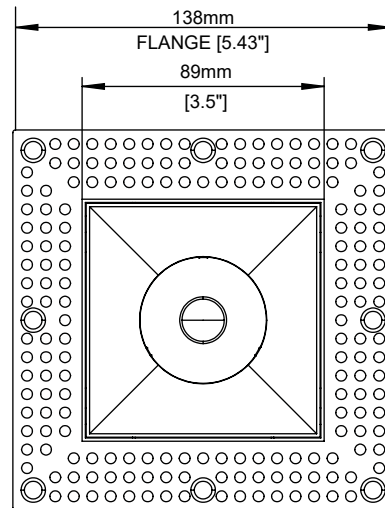
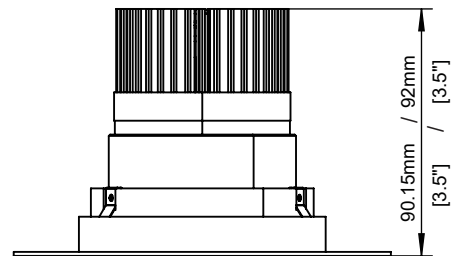

 CUT-OUT : [3.6"] Ø91.6mm X [3.6"] Ø91.6mm

\*All Dimensions are millimeters (Inches) unless otherwise indicated.



Warranty



Damp Rated



TRIAC



Dimming



Intertek

# INSPIRA 3

## Product Details:

New construction housing plate for Square Downlight

Part number - 503047

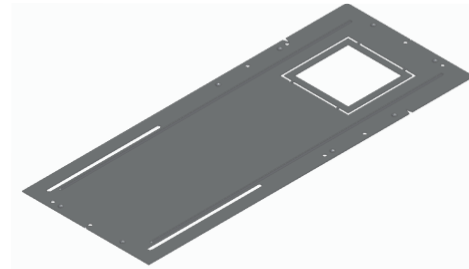
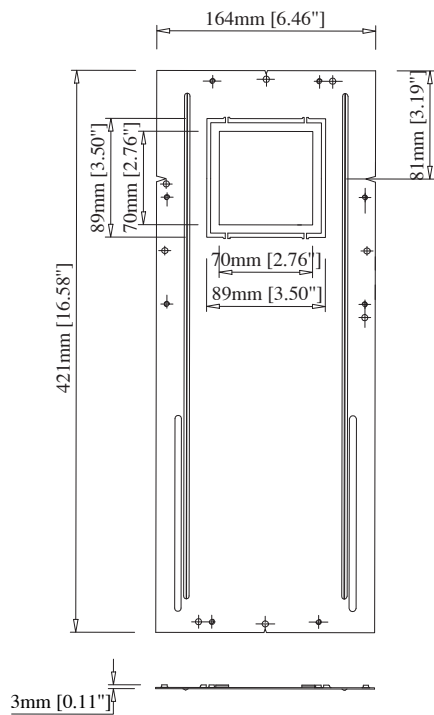

# INSPIRA 3

## Photometric:

### Square Fixed -12W-36D

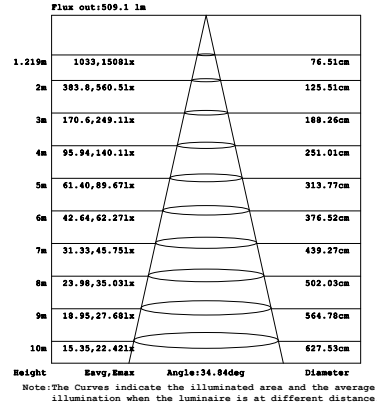
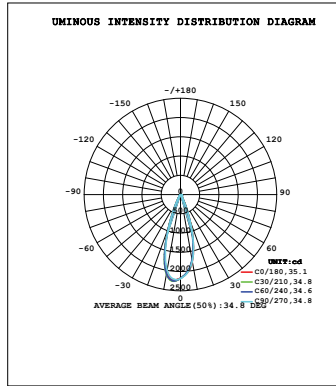

### Square Fixed -14W-36D

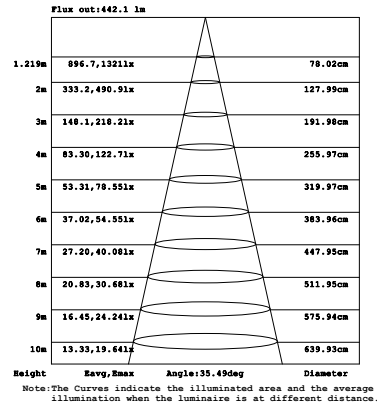
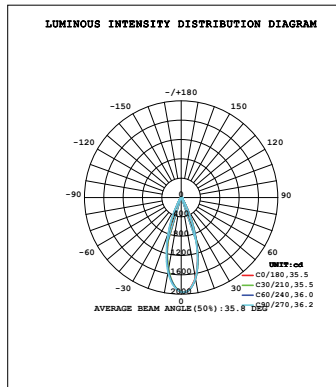

## Lighting Chart:

WATT	LUMENS	CCT	CRI
12W	1000 lm	3000K	CRI90
14W	1200 lm	3000K	CRI90
24W	2200 lm	3000K	CRI90



# INSPIRA 3

## Technical Details:

Material	Aluminium
Trim Options	Trim / Trimless
Trim Style	Fixed
Trim Finish	White / Black
Lumens	Upto 2200lm
Wattage	12W / 14W / 24W
Efficacy	80 Lm/W
UGR	<19
CRI	90+
CCT	2700K / 3000K / 3500K / 4000K / 5000K
	/ Dim To Warm (DTW)
Beam Angle	15° / 24° / 36° / 60°
Dimming	TRIAC / 0-10V
Voltage	120V / 120-277V
Life expectancy	LM 80 > 66,000 Hrs. / LM 70 > 66,000 Hrs.
Operating Temp.	-20°C ~ 40°C (-4°F ~ 104°F)
Housing	Non IC Rated / IC Rated / Remodel
Certification	ETL LISTED / DAMP RATED

