

Type: _____ Qty: _____

Project: _____



HELIUM LYTE

INSPIRA 3

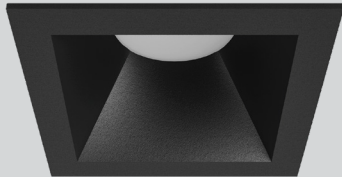

Square Trim

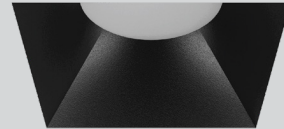

Square Trimless

Design Features:

- Inspira 2D fixed 3" Downlight offers specification-grade performance and features, in a completely modular & field-configurable system. Every light engine integrates with any of the trims, and every trim works with all of the ceiling application and housing options.
- Made with high powered BRIDGELUX led chip that maintains high lumens per watt with 90 +CRI / Fixture comes with both Single CCT and Dim To Warm options.
- Available in both TRIAC and 0-10V dimming.
- Standard remodel installation, new construction housing available.
- LED modules and drivers are easily replaceable.
- Extruded aluminium heat sink ensures optimal heat dissipation and LED life.
- 5 Year warranty.



Warranty



Damp Rated



TRIAC



Dimming



Intertek

INSPIRA 3

Specs Code:

FIXTURE ID 1	TRIM OPTION 2	TRIM FINISH 3	LUMENS/ WATT 4	LED OPTION 5
Inspira 3 Square INS3SQ	Trim TRM	White WH	L1000 / 12W L10/12W	2700K 27K
	Trimless TRML	Black BLK	L1200 / 14W L12/14W	3000K 30K
		Custom CSTM	L2200 / 24W L22/24W	3500K 35K
				4000K 40K
				5000K 50K
				Dim To Warm DTW
BEAM ANGLE 6	DIMMING 7	HOUSING* 8	VOLTAGE 9	
15 Degree 15D	TRIAC TRIAC 0-10V DMV	New Construction NC	120V 120V	
24 Degree 24D		Remodel RMOD	120-277V UNV	
36 Degree 36D				
60 Degree 60D				

*Inspira is not available with an IC box configuration.

Order Guide:

1	2	3	4	5	6
7	8	9			

*Example : INS3SQ-TRM-BLK-L10/12W-40K-60D-TRIAC-NC-UNV



INSPIRA 3

Product Details:

Square Bevel Trim Fixed

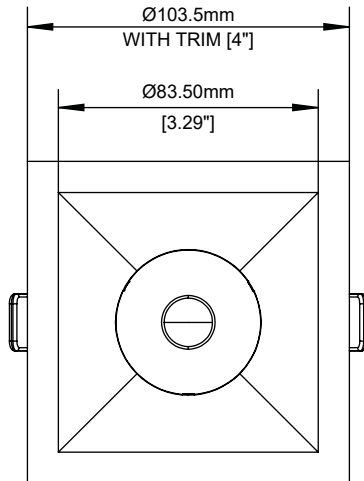
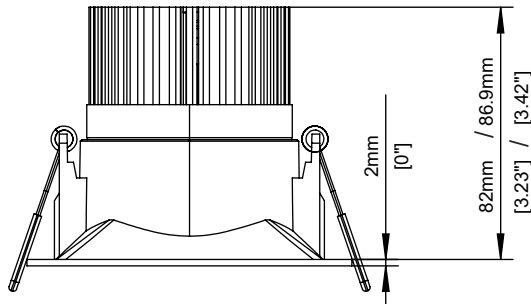

 CUT-OUT : [3.38"] Ø86mm X [3.38"] Ø86mm

Square Bevel Trimless Fixed

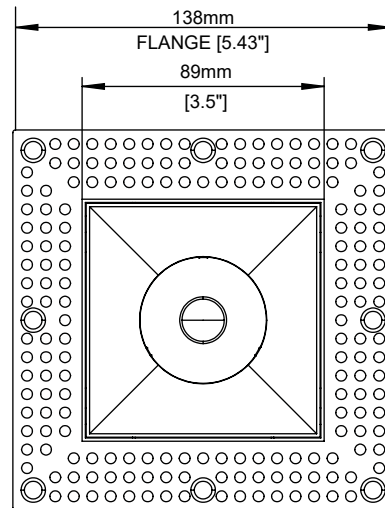
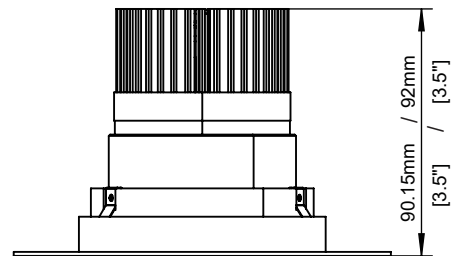

 CUT-OUT : [3.6"] Ø91.6mm X [3.6"] Ø91.6mm

*All Dimensions are millimeters (Inches) unless otherwise indicated.

5
Year
Warranty

IP44
Damp Rated

TRIAC

0-10V
Dimming



Intertek

INSPIRA 3

Product Details:

New construction housing plate for Square Downlight

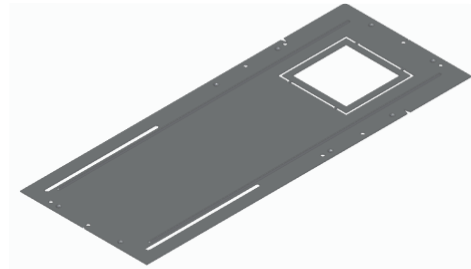
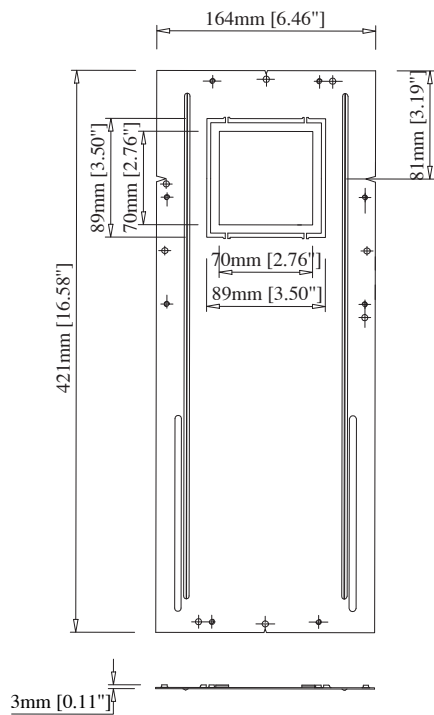
Part number - 503047



INSPIRA 3

Photometric:

Square Fixed -12W-36D

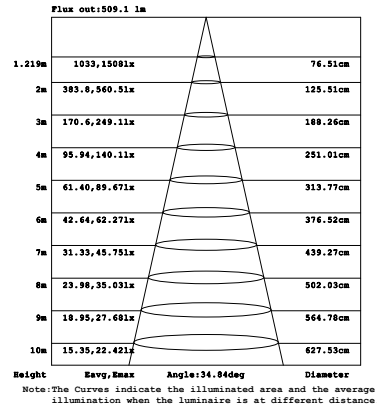
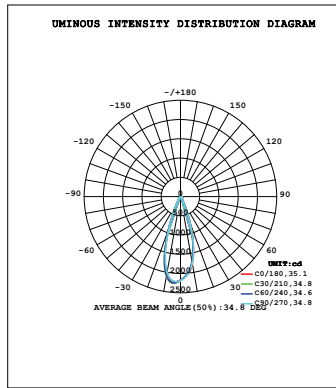

Square Fixed -14W-36D

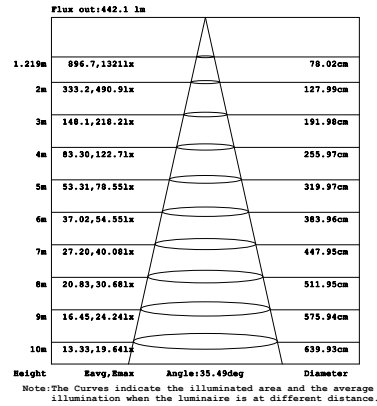
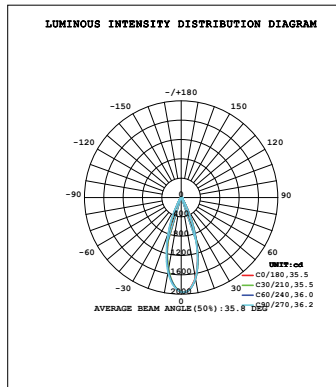

Lighting Chart:

WATT	LUMENS	CCT	CRI
12W	1000 lm	3000K	CRI90
14W	1200 lm	3000K	CRI90
24W	2200 lm	3000K	CRI90



INSPIRA 3

Technical Details:

Material	Aluminium
Trim Options	Trim / Trimless
Trim Style	Fixed
Trim Finish	White / Black
Lumens	Upto 2200lm
Wattage	12W / 14W / 24W
Efficacy	80 Lm/W
UGR	<19
CRI	90+
CCT	2700K / 3000K / 3500K / 4000K / 5000K
	/ Dim To Warm (DTW)
Beam Angle	15° / 24° / 36° / 60°
Dimming	TRIAC / 0-10V
Voltage	120V / 120-277V
Operating Temp.	-20°C ~ 40°C (-4°F ~ 104°F)
Housing	Non IC Rated / Remodel
Certification	ETL LISTED / DAMP RATED

