

Type:\_\_\_\_\_ Qty:\_\_\_\_\_

Project:\_\_\_\_\_



HELIUM LYTE

# INSPIRA MULTI

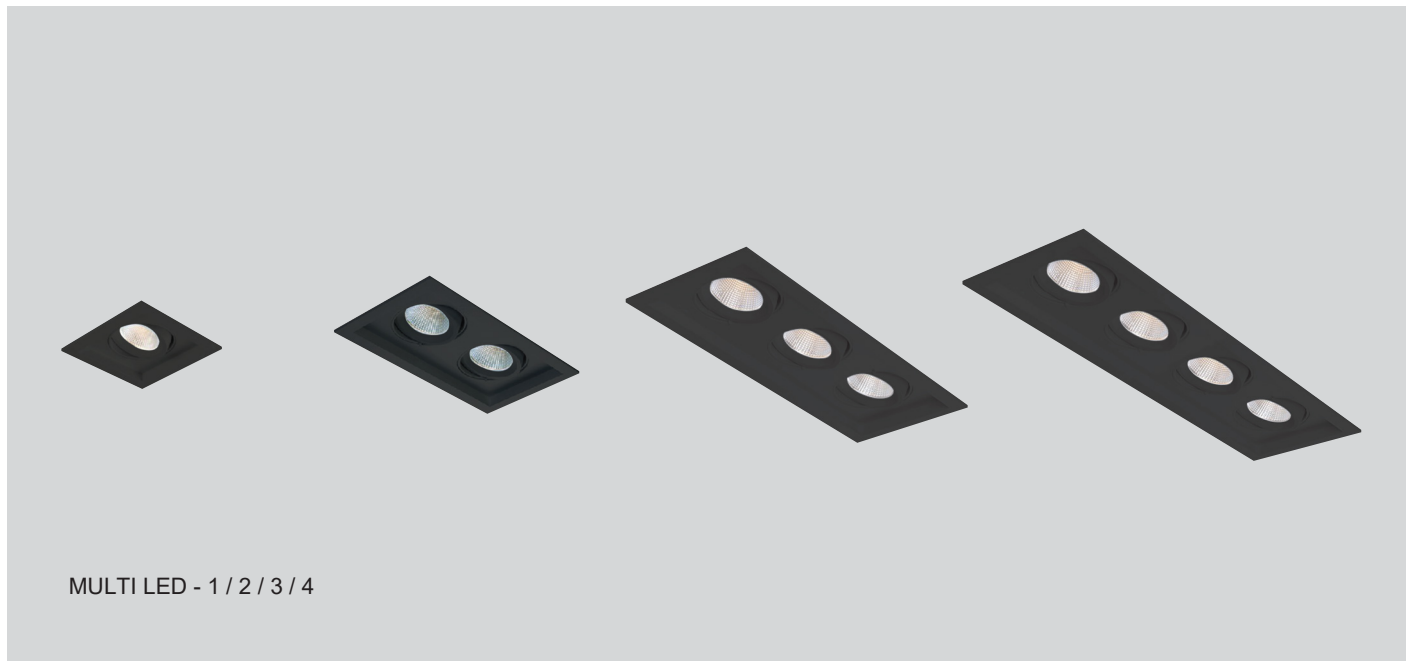

MULTI LED - 1 / 2 / 3 / 4

## Design Features:

- Made with high powered BRIDGELUX led chip that maintains high lumens per watt with 90 +CRI / Fixture comes with both Single CCT and Dim To Warm options.
- The gimbal led heads can rotate 360 degree horizontally and tilt 30 degree.
- Integral thermal protection provided on Non-IC models to indicate improper installations.
- Available in both TRIAC and 0-10V dimming.
- LED modules and drivers are easily replaceable.
- Standard remodel installation, new construction housing available.
- Extruded aluminium heat sink ensures optimal heat dissipation and LED life.
- 5 Year warranty.



Warranty



Damp Rated



TRIAC



Dimming



Intertek

# INSPIRA MULTI

## Specs Code:

FIXTURE ID <span>1</span>	TRIM OPTION <span>2</span>	TRIM FINISH <span>3</span>	NO. OF LIGHTS / LUMENS / WATT <span>4</span>	
Inspira Multi <b>INS-MULTI</b>	Trim <b>TRM</b>	White Black Custom <b>WH</b> <b>BLK</b> <b>CSTM</b>	1 Light - L700 / 10W 2 Light - L1400 / 20W 3 Light - L2100 / 30W 4 Light - L2800 / 40W	<b>1L-L70/10W</b> <b>2L-L14/20W</b> <b>3L-L21/30W</b> <b>3L-L28/40W</b>
LED OPTION <span>5</span>	BEAM ANGLE <span>6</span>	DIMMING <span>7</span>	HOUSING* <span>8</span>	VOLTAGE <span>9</span>
2700K 3000K 3500K 4000K 5000K Dim To Warm <b>27K</b> <b>30K</b> <b>35K</b> <b>40K</b> <b>50K</b> <b>DTW</b>	15 Degree 24 Degree 36 Degree <b>15D</b> <b>24D</b> <b>36D</b>	TRIAC 0-10V <b>TRIAC</b> <b>DMV</b>	New Construction Remodel <b>NC</b> <b>RMOD</b>	120V 120-277V <b>120V</b> <b>UNV</b>

\*Inspira is not available with an IC box configuration.

## Order Guide:

1

2

3

4

5

6

7

8

9

\*Example : INS-MULTI-TRM-BLK-1L-L70/10W-40K-36D-TRIAC-NC-UNV



# INSPIRA MULTI

## Product Details:

### MULTI LED - 1 Light

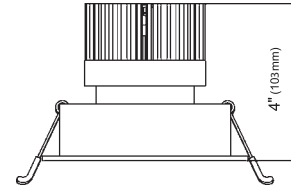
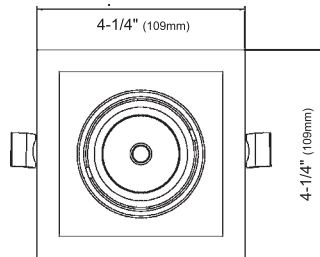
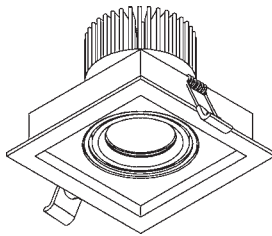

CUT-OUT : 3-3/4" × 3-7/8" (95mm × 98mm)

### MULTI LED - 2 Light

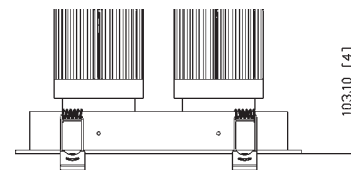
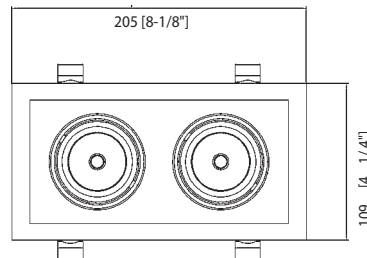
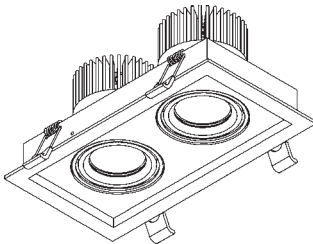

CUT-OUT : 3-7/8" × 7-1/2" (98mm × 190mm)

\*All Dimensions are millimeters (Inches) unless otherwise indicated.



Warranty



Damp Rated



TRIAC



Dimming



Intertek

# INSPIRA MULTI

## Product Details:

### MULTI LED - 3 Light

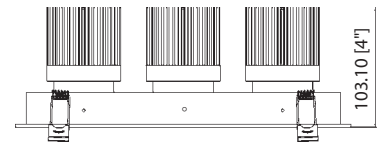
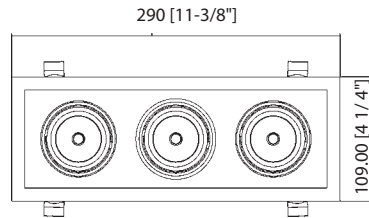
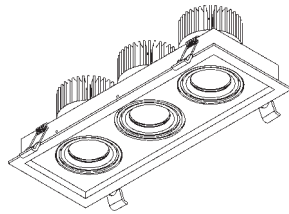

CUT-OUT : 3-7/8" × 10-13/16" (98mm × 275mm)

### MULTI LED - 4 Light

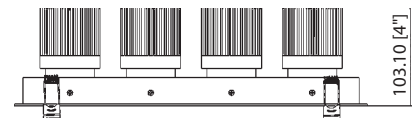
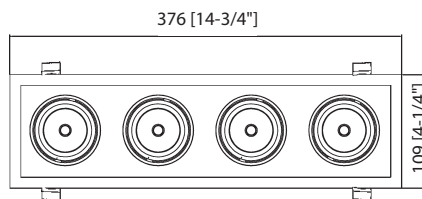
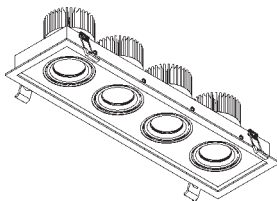

CUT-OUT : 3-7/8" × 14-1/4" (98mm × 361 mm)

\*All Dimensions are millimeters (Inches) unless otherwise indicated.



Warranty



Damp Rated



TRIAC



Dimming



Intertek

# INSPIRA MULTI

## Product Details:

New construction housing plate for Multi Downlight

Part number - 503048

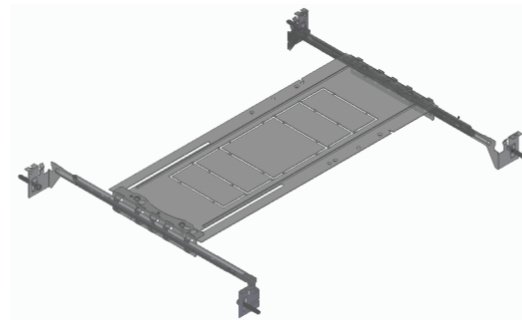
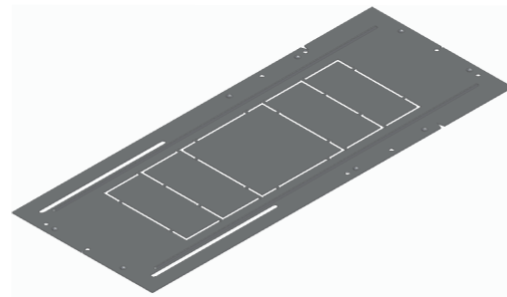
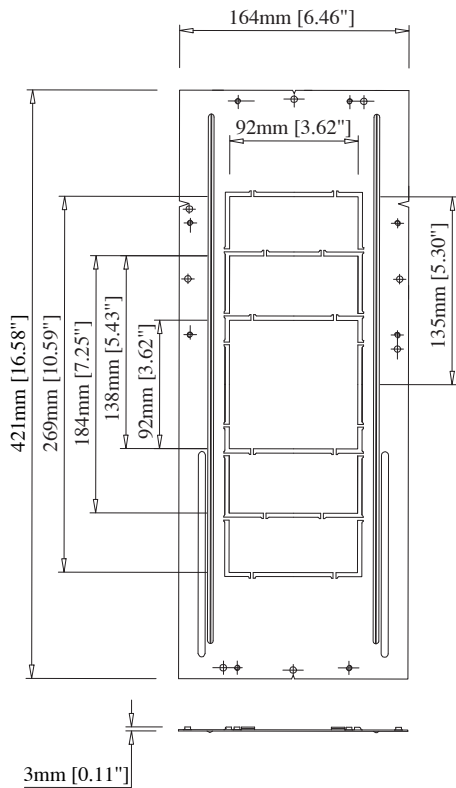

Warranty



Damp Rated



Dimming



Dimming



Intertek

# INSPIRA MULTI

Photometric:

Round -10W-36D

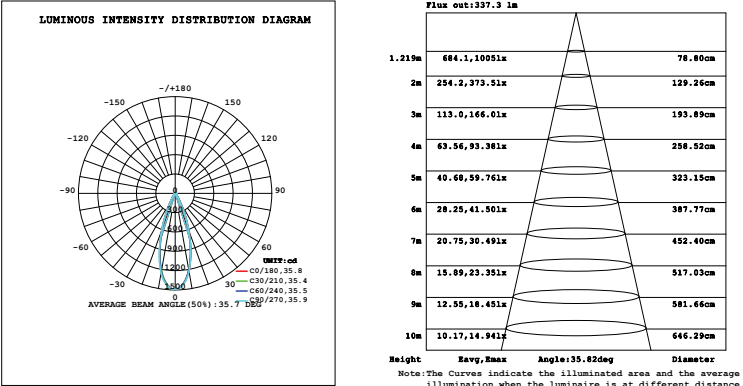

Lighting Chart:

WATT	LUMENS	CCT	CRI
10W	700 lm	3000K	CRI90
20W	1400 lm	3000K	CRI90
30W	2100 lm	3000K	CRI90
40W	2800 lm	3000K	CRI90



# INSPIRA MULTI

## Technical Details:

Material	Aluminium
Trim Options	Trim
Trim Style	Fixed
Trim Finish	White / Black
Lumens	Upto 2800lm
No.of Light -Wattage	1L-10W / 2L-20W / 3L-30W / 4L-40W
Efficacy	70 Lm/W
UGR	<19
CRI	90+
CCT	2700K / 3000K / 3500K / 4000K / 5000K
	/ Dim To Warm (DTW)
Beam Angle	15° / 24° / 36°
Dimming	TRIAC / 0-10V
Voltage	120V / 120-277V
Operating Temp.	-20°C ~ 40°C (-4°F ~ 104°F)
Housing	Non IC Rated / Remodel
Certification	ETL LISTED / DAMP RATED

